

Call Before  
 You Dig!  
**811**

Rev #	Date	Description
1	8/23/23	Grading Plan

Sta10 Project #:	23004
Submittal:	Permit

**Bike Skills Area at Deane's Children's Park**  
 5701 Island Crest Way  
 Mercer Island, WA 98040

Design:	SEH
Drafting:	--
Checked:	SEH
Date:	6/28/23

**Grading Plan**

Sheet: **C3.0**

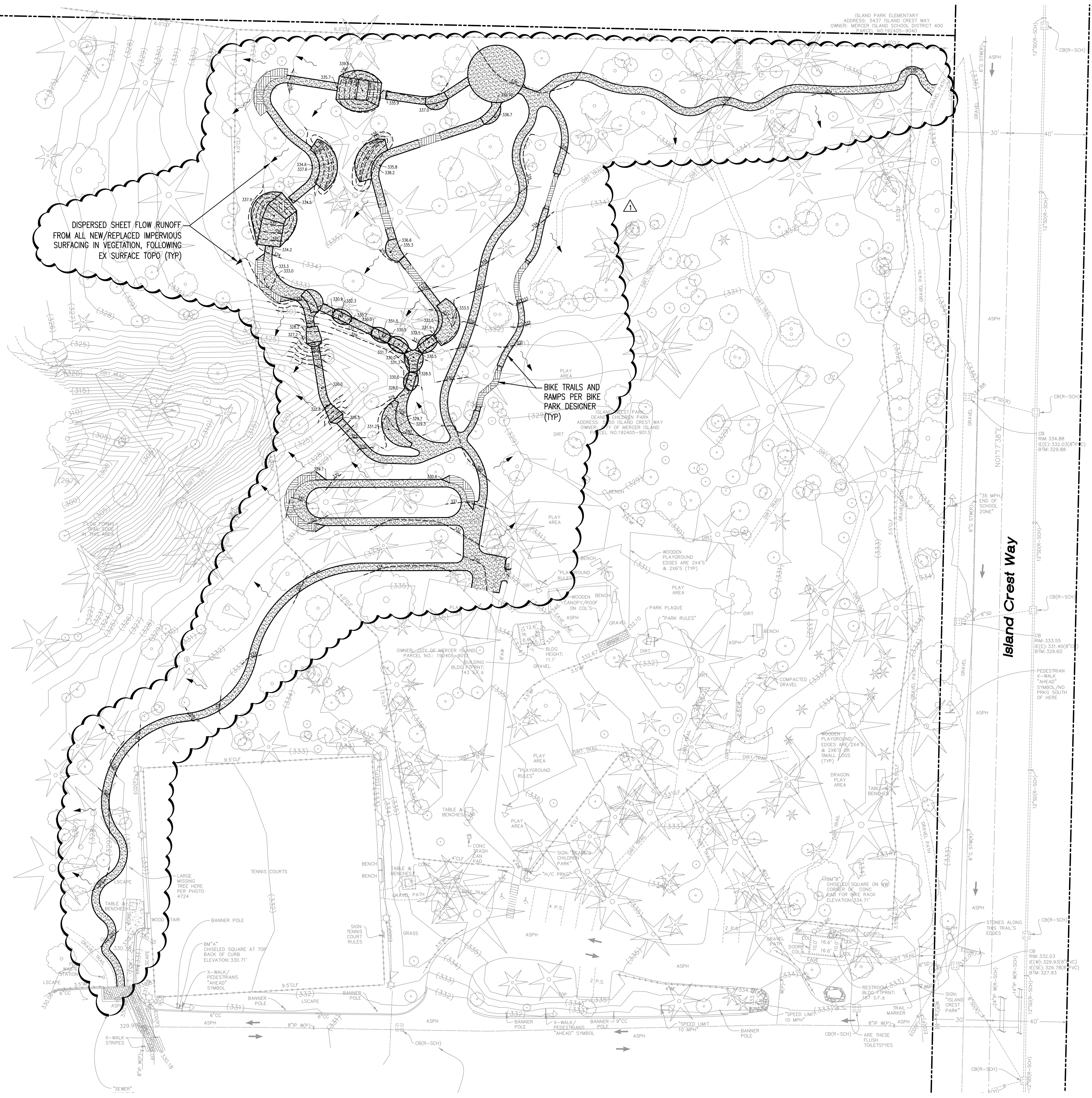

**Datum**  
 NAVD 88

**Legend**

- COMPACTED DIRT SURFACING
- WOOD DECKING
- DISPERSION IN VEGETATION
- FINISHED GRADE (FG) ELEVATION
- FG CONTOUR

**Notes**

- SEE SHEET C2.0 FOR GENERAL NOTES.
- PERFORM SUBGRADE PREPARATION IN ACCORDANCE WITH THE REQUIREMENTS AND RECOMMENDATIONS OF GEOTECHNICAL REPORT PREPARED FOR THIS PROJECT.
- FINISHED GRADE INDICATED IS FINAL SURFACE ELEVATION FOLLOWING PLACEMENT OF ALL SURFACING MATERIALS.
- GRADE ALL AREAS TO PROVIDE DRAINAGE IN THE DIRECTION NOTED.
- COORDINATE AND VERIFY LAYOUT OF ALL NEW WALKWAYS WITH OWNER PRIOR TO PERFORMING ANY PREPARATION OR INSTALLATION WORK.
- FINE GRADE AREAS TO DIRECT SURFACE RUNOFF OFF OF TRAILS INTO VEGETATION.
- THE SITE IS SUBJECT TO RESTRICTIONS ON GRADING AND CONSTRUCTION ACTIVITIES DURING THE WET SEASON. LAND DISTURBING ACTIVITIES ARE RESTRICTED FROM OCTOBER 1st TO APRIL 30th UNLESS A WET SEASON CONSTRUCTION REQUEST IS SUBMITTED, REVIEWED, AND A WET SEASON CONSTRUCTION APPROVAL LETTER IS GRANTED BY THE CITY OF MERCER ISLAND.